



**San Diego Unified**  
SCHOOL DISTRICT

The City of

**SAN DIEGO**

---

# Canyon Hills High School Joint-Use Field

**October 10, 2024**

# Previous Joint-Use Configuration

## Previous Joint Use Area

- 4.71 acres of natural turf
- 0.95 acres of tennis courts

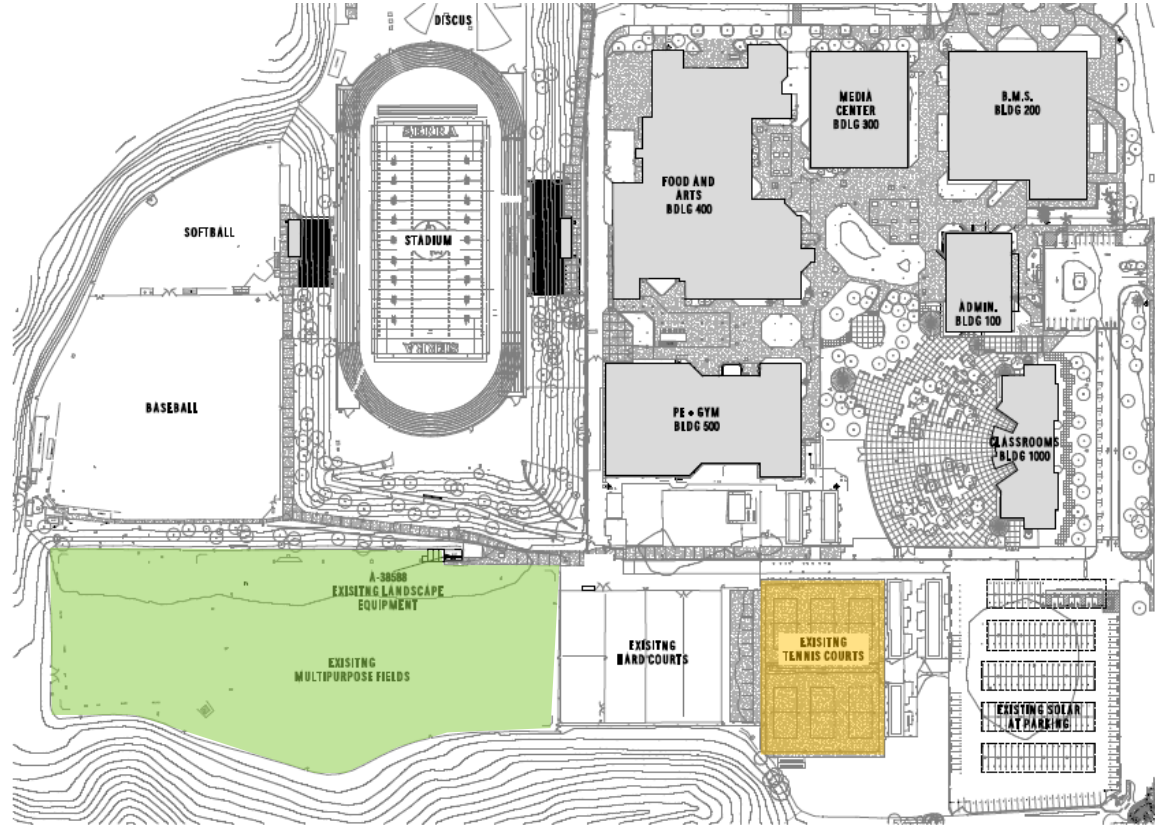

# Whole Site Modernization Project

## Reduced Joint Use Area

- 2.5 acres of natural turf
- 0.95 acres of tennis courts

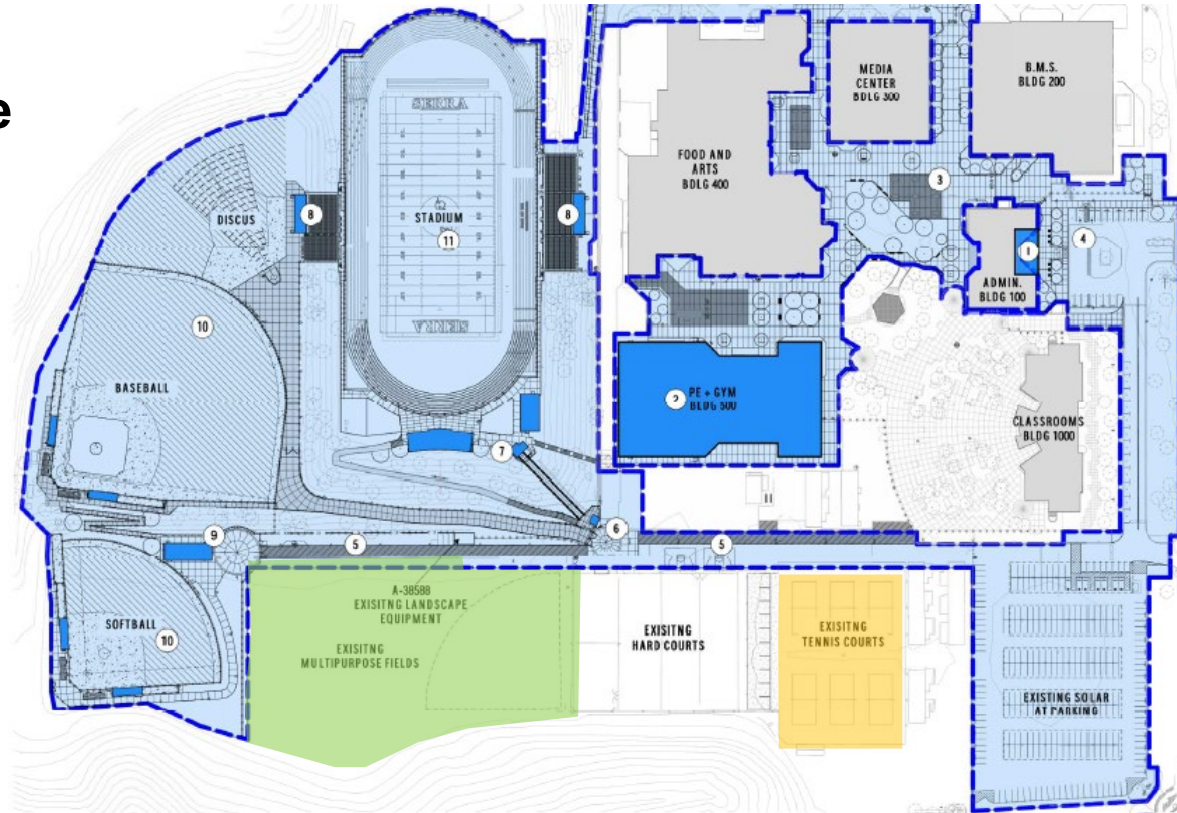

# Adjustment of Joint Use Hours



## High School CIF Sports Field Use

- **Public use hours start after 6pm on school days (Joint Use Field only)**
- **Closed on some Saturdays (Joint Use Field only)**
- **All Sundays, holidays, school breaks**



**Gene Fuller**  
Director, Real Estate  
Facilities Planning & Construction  
TEL: (619) 278-6721  
FAX: (858) 541-7854  
gfuller@sandi.net

### MEMORANDUM

**TO:** Andy Field, Director, Parks and Recreation  
**FROM:** Gene Fuller, Director, Real Estate  
**DATE:** May 22, 2023  
**SUBJECT:** Canyon Hills High Joint-Use Field Adjustment to School Use Hours

Due to the increase of California Interscholastic Federation approved athletics, the District requires an adjustment of school use hours on school days at Canyon Hills High (formerly Serra High) for the joint use field only.

Starting August 21, 2023, the joint use field will be opened for public use at 6:00 p.m. on school days. The joint use tennis courts will not be impacted by these modified hours.

See attached site map indicating joint use field and joint use tennis courts

There is no change to the schedule for weekends and holidays when school is not in session on weekends, holidays and school breaks; both the field and tennis courts are available for public use.

Thank you for your continued collaboration.

Sincerely,

A handwritten signature in blue ink that reads 'Gene W. Fuller'.

Gene Fuller  
Director, Real Estate

C: Gina Dulay, Shannon Scoggins, Jerry Abbott, Jonn Pisapia

# Community Input

- **High School Joint Use field use requires reduced public use times due to CIF sports use**
- **Maintenance challenges irrigation coverage**
- **Entire JU area will be closed during WSM construction from November 2025 – May 2026**



- **The Department is seeking input from the CRG on the following:**

**Should Canyon Hills HS be removed from Joint Use?**

**Action Item: November 14**



**San Diego Unified**  
SCHOOL DISTRICT

The City of  
**SAN DIEGO**

---

# Canyon Hills High School Joint-Use Field Action Item November 14, 2024

# Previous Joint-Use Configuration

## Previous Joint Use Area

- 4.71 acres of natural turf
- 0.95 acres of tennis courts

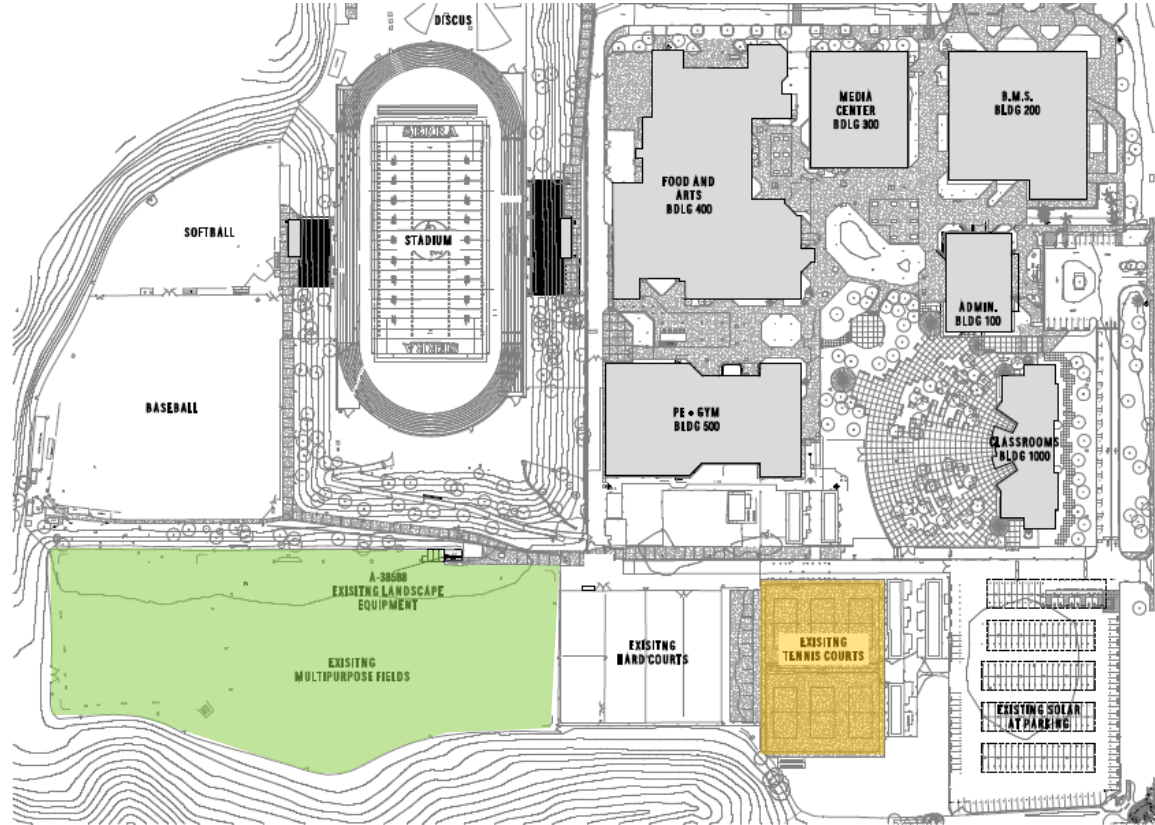

# Whole Site Modernization Project

## Reduced Joint Use Area

- 2.5 acres of natural turf
- 0.95 acres of tennis courts

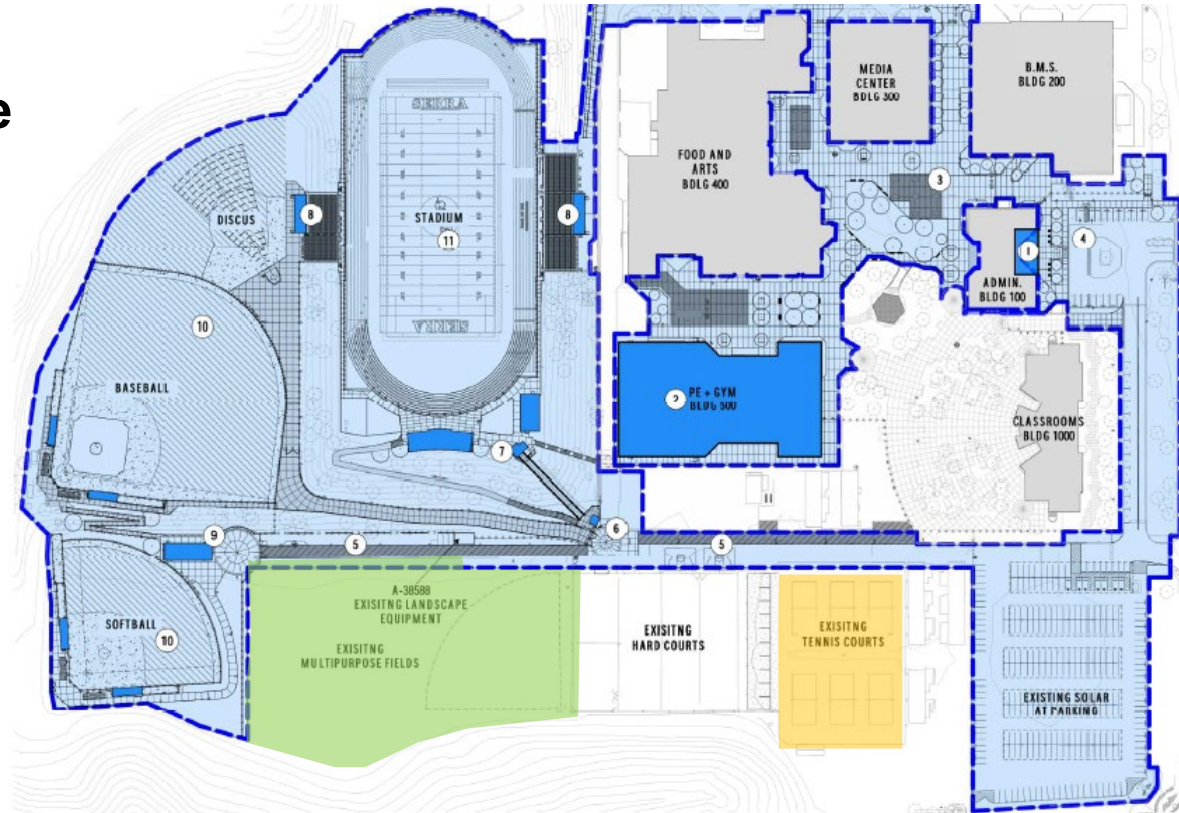

# Adjustment of Joint Use Hours



## High School CIF Sports Field Use

- **Public use hours start after 6pm on school days (Joint Use Field only)**
- **Closed on some Saturdays (Joint Use Field only)**
- **All Sundays, holidays, school breaks**



**Gene Fuller**  
Director, Real Estate  
Facilities Planning & Construction  
TEL: (619) 278-6721  
FAX: (858) 541-7854  
gfuller@sandi.net

### MEMORANDUM

**TO:** Andy Field, Director, Parks and Recreation  
**FROM:** Gene Fuller, Director, Real Estate  
**DATE:** May 22, 2023  
**SUBJECT:** Canyon Hills High Joint-Use Field Adjustment to School Use Hours

Due to the increase of California Interscholastic Federation approved athletics, the District requires an adjustment of school use hours on school days at Canyon Hills High (formerly Serra High) for the joint use field only.

Starting August 21, 2023, the joint use field will be opened for public use at 6:00 p.m. on school days. The joint use tennis courts will not be impacted by these modified hours.

See attached site map indicating joint use field and joint use tennis courts

There is no change to the schedule for weekends and holidays when school is not in session on weekends, holidays and school breaks; both the field and tennis courts are available for public use.

Thank you for your continued collaboration.

Sincerely,

A handwritten signature in blue ink that reads 'Gene W. Fuller'.

Gene Fuller  
Director, Real Estate

C: Gina Dulay, Shannon Scoggins, Jerry Abbott, Jonn Pisapia

# Community Input

- **High School Joint Use field use requires reduced public use times due to CIF sports use**
- **Maintenance challenges irrigation coverage**
- **Entire JU area will be closed during WSM construction from November 2025 – May 2026**



# Next steps

---



- **The Department is seeking input from the CRG on the following:**

**Should Canyon Hills HS be removed from Joint Use?**